

# Extrusion Product Guide

## Guide for Standard Extruded Shapes (Profiles)

### Profile Description: Solid O-Shape

Chomerics has or will build tooling for all outside diameters between 0.030 - 0.500 inch (0.76 - 12.7 mm). Please consult with an Applications Engineer if the size you need is not shown in the table, and part numbers will be assigned.

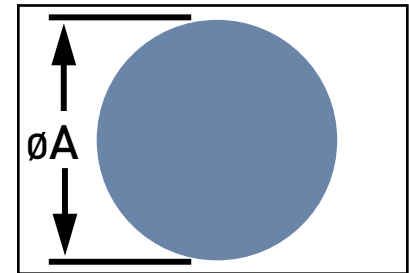

Table 8: Profiles, Solid O-Shape (Sorted by "A" Dimension)

Part Number	Nominal Dimension		Suggested Groove Dimensions*			
	A		Depth		97% Max Groove Fill	
	inch	mm	inch	mm	inch	mm
19-04-W993-XXXX	0.030	0.76	-	-	-	-
19-04-12897-XXXX	0.033	0.84	-	-	-	-
19-04-23913-XXXX	0.035	0.89	-	-	-	-
19-04-22085-XXXX	0.040	1.02	0.029	0.74	0.063	1.60
19-04-22533-XXXX	0.043	1.09	0.032	0.81	0.064	1.63
10-04-9139-XXXX	0.048	1.22	0.037	0.94	0.067	1.70
19-04-22087-XXXX	0.050	1.27	0.038	0.97	0.070	1.78
10-04-3560-XXXX	0.053	1.35	0.041	1.04	0.072	1.83
19-04-22354-XXXX	0.060	1.52	0.047	1.19	0.078	1.98
10-04-2561-XXXX	0.062	1.57	0.049	1.24	0.079	2.01
19-04-22049-XXXX	0.066	1.68	0.053	1.34	0.082	2.08
19-04-22951-XXXX	0.070	1.78	0.056	1.42	0.086	2.18
10-04-1687-XXXX	0.070	1.78	0.056	1.42	0.086	2.18
19-04-24514-XXXX	0.073	1.85	0.059	1.50	0.088	2.24
19-04-12898-XXXX	0.074	1.88	0.060	1.52	0.089	2.26
19-04-11228-XXXX	0.075	1.90	0.061	1.55	0.090	2.29
19-04-12899-XXXX	0.077	1.96	0.063	1.60	0.091	2.31
19-04-12900-XXXX	0.079	2.01	0.064	1.63	0.094	2.39
10-04-2657-XXXX	0.080	2.03	0.065	1.65	0.095	2.41
19-04-12901-XXXX	0.085	2.16	0.069	1.75	0.100	2.54
19-04-M394-XXXX	0.090	2.29	0.074	1.88	0.103	2.62
10-04-2865-XXXX	0.093	2.36	0.076	1.93	0.107	2.72
10-04-3509-XXXX	0.100	2.54	0.082	2.08	0.113	2.87
10-04-1720-XXXX	0.103	2.69	0.084	2.13	0.117	2.97
19-04-12902-XXXX	0.106	2.62	0.087	2.21	0.119	3.02
10-04-2866-XXXX	0.112	2.84	0.092	2.34	0.125	3.17
19-04-22993-XXXX	0.115	2.92	0.094	2.39	0.129	3.28
10-04-3077-XXXX	0.119	3.02	0.102	2.59	0.131	3.33
10-04-2463-XXXX	0.125	3.17	0.107	2.71	0.139	3.53
10-04-2862-XXXX	0.130	3.30	0.110	2.79	0.142	3.61
19-04-12903-XXXX	0.134	3.40	0.112	2.84	0.146	3.71

Part Number	Nominal Dimension		Suggested Groove Dimensions			
	A		Depth		97% Max Groove Fill	
	inch	mm	inch	mm	inch	mm
19-04-23338-XXXX	0.136	3.45	0.112	2.84	0.148	3.76
10-04-1721-XXXX	0.139	3.53	0.114	2.90	0.152	3.86
19-04-12904-XXXX	0.147	3.73	0.120	3.05	0.160	4.06
10-04-3982-XXXX	0.150	3.81	0.123	3.12	0.163	4.14
19-04-12906-XXXX	0.158	4.01	0.129	3.28	0.171	4.34
10-04-3231-XXXX	0.160	4.06	0.131	3.33	0.173	4.39
19-04-12907-XXXX	0.170	4.32	0.139	3.53	0.182	4.62
19-04-F371-XXXX	0.188	4.78	0.154	3.91	0.200	5.08
19-04-12908-XXXX	0.195	4.95	0.160	4.06	0.207	5.26
19-04-20919-XXXX	0.210	5.33	0.173	4.39	0.227	5.77
10-04-2864-XXXX	0.216	5.49	0.177	4.50	0.234	5.94
19-04-12909-XXXX	0.219	5.56	0.179	4.55	0.238	6.04
19-04-12910-XXXX	0.236	5.99	0.193	4.90	0.254	6.45
19-04-12911-XXXX	0.247	6.27	0.202	5.13	0.265	6.73
19-04-25051-XXXX	0.275	6.99	0.226	5.74	0.291	7.39
10-04-3076-XXXX	0.250	6.35	0.205	5.21	0.268	6.81
10-04-9769-XXXX	0.280	7.11	0.230	5.84	0.297	7.54
19-04-12912-XXXX	0.291	7.39	0.238	6.04	0.309	7.85
19-04-12918-XXXX	0.367	9.32	0.301	7.64	0.387	9.83
19-04-12919-XXXX	0.379	9.63	0.310	7.87	0.400	10.16
19-04-12920-XXXX	0.393	9.98	0.322	8.18	0.413	10.49

Standard Tolerances (inch)

<0.200: ±0.005

0.200 - 0.349: ±0.008

0.350 - 0.500: ±0.010

>0.500: ±3% Nom. Dim.

Dimensions listed for reference only.

Please see Chomerics drawing for revision-controlled specifications.

\*Contact Chomerics Applications Engineering for groove design assistance.

### Profile Description: Hollow O Shape

Chomerics has or will build tooling for all outside diameters between 0.030 -0.500 inch (0.76 - 12.7 mm). Please consult with an Applications Engineer if the size you need is not shown in the table, and part numbers will be assigned.

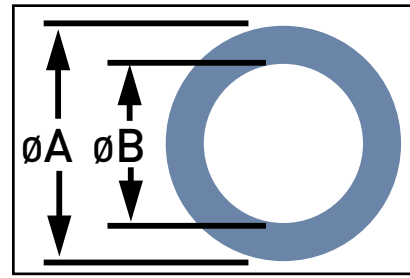

Table 9: Profiles, Hollow-O-Shape (Sorted by "A" Dimension)

Part Number	Nominal Dimension (inch)		Nominal Dimension (mm)	
	A	B	A	B
10-04-21120-XXXX	0.053	0.020	1.35	0.51
10-04-W137-XXXX	0.060	0.020	1.52	0.51
10-04-W163-XXXX	0.062	0.035	1.57	0.89
19-04-22710-XXXX	0.063	0.023	1.60	0.58
19-04-14964-XXXX	0.070	0.020	1.78	0.51
19-04-22129-XXXX	0.073	0.033	1.85	0.84
19-04-24444-XXXX	0.074	0.020	1.88	0.51
19-04-23365-XXXX	0.075	0.045	1.90	1.14
19-04-15465-XXXX	0.080	0.030	2.03	0.76
19-04-14206-XXXX	0.080	0.040	2.03	1.02
19-04-11204-XXXX	0.081	0.020	2.06	0.51
19-04-22678-XXXX	0.083	0.043	2.11	1.09
19-04-12570-XXXX	0.083	0.050	2.11	1.27
19-04-23086-XXXX	0.090	0.020	2.29	0.51
10-04-W267-XXXX	0.090	0.050	2.29	1.27
10-04-W293-XXXX	0.090	0.060	2.229	1.52
19-04-19890-XXXX	0.093	0.033	2.36	0.84
19-04-22970-XXXX	0.093	0.033	2.36	0.84
19-04-20072-XXXX	0.093	0.040	2.36	1.02
19-04-12744-XXXX	0.100	0.060	2.54	1.52
19-04-16162-XXXX	0.100	0.070	2.54	1.78
19-04-11205-XXXX	0.102	0.039	2.59	0.99
19-04-20946-XXXX	0.102	0.051	2.59	1.30
10-04-8363-XXXX	0.103	0.040	2.62	1.02
19-04-24415-XXXX	0.103	0.053	2.62	1.35
19-04-24652-XXXX	0.103	0.075	2.62	1.90
19-04-11218-XXXX	0.110	0.045	2.79	1.14
19-04-14120-XXXX	0.110	0.062	2.79	1.57
19-04-15278-XXXX	0.110	0.068	2.79	1.73
19-04-15586-XXXX	0.118	0.050	3.00	1.27
19-04-12534-XXXX	0.118	0.079	3.00	2.01
19-04-11216-XXXX	0.122	0.061	3.10	1.55
10-04-2999-XXXX	0.125	0.045	3.17	1.14
19-04-23836-XXXX	0.125	0.055	3.17	1.40
10-04-8817-XXXX	0.125	0.062	3.17	1.57
19-04-13564-XXXX	0.125	0.070	3.17	1.78
10-04-W204-XXXX	0.125	0.078	3.17	1.98

Part Number	Nominal Dimension (inch)		Nominal Dimension (mm)	
	A	B	A	B
19-04-11283-XXXX	0.125	0.080	3.17	2.03
10-04-W775-XXXX	0.125	0.085	3.17	2.16
19-04-23097-XXXX	0.130	0.090	3.30	2.29
10-04-5514-XXXX	0.135	0.045	3.43	1.14
19-04-16390-XXXX	0.135	0.045	3.43	1.14
19-04-16104-XXXX	0.135	0.055	3.43	1.40
19-04-16009-XXXX	0.135	0.085	3.43	2.16
19-04-X787-XXXX	0.135	0.097	3.43	2.46
19-04-14632-XXXX	0.137	0.087	3.48	2.21
19-04-11497-XXXX	0.140	0.046	3.56	1.17
19-04-11289-XXXX	0.145	0.070	3.68	1.78
19-04-13118-XXXX	0.145	0.080	3.68	2.03
19-04-14930-XXXX	0.151	0.094	3.84	2.39
19-04-21919-XXXX	0.153	0.105	3.89	2.67
19-04-13545-XXXX	0.153	0.115	3.89	2.92
19-04-23209-XXXX	0.156	0.035	3.96	0.89
10-04-4180-XXXX	0.156	0.050	3.96	1.27
10-04-9732-XXXX	0.156	0.080	3.96	2.03
10-04-8133-XXXX	0.177	0.079	4.50	2.01
19-04-21639-XXXX	0.177	0.090	4.50	2.29
19-04-13189-XXXX	0.177	0.110	4.50	2.79
19-04-20982-XXXX	0.177	0.125	4.50	3.17
19-04-22324-XXXX	0.177	0.137	4.50	3.48
19-04-11214-XXXX	0.180	0.140	4.57	3.56
19-04-12128-XXXX	0.188	0.125	4.78	3.17
19-04-14537-XXXX	0.189	0.111	4.80	2.82
10-04-4254-XXXX	0.190	0.080	4.83	2.03
19-04-21194-XXXX	0.195	0.155	4.95	3.94
19-04-12015-XXXX	0.207	0.077	5.26	1.96
19-04-15435-XXXX	0.207	0.090	5.26	2.29
19-04-16084-XXXX	0.207	0.134	5.26	3.40
19-04-E483-XXXX	0.210	0.093	5.33	2.36
19-04-22066-XXXX	0.210	0.100	5.33	2.54
19-04-15479-XXXX	0.210	0.120	5.33	3.05
19-04-C627-XXXX	0.216	0.090	5.49	2.29
19-04-20848-XXXX	0.220	0.170	5.59	4.32
19-04-23158-XXXX	0.236	0.118	5.99	3.00

Table 9: Profiles, Hollow-O-Shape (Sorted by "A" Dimension) (Cont.)

Part Number	Nominal Dimension (inch)		Nominal Dimension (mm)	
	A	B	A	B
19-04-21163-XXXX	0.250	0.110	6.35	2.79
10-04-2737-XXXX	0.250	0.125	6.35	3.17
19-04-15434-XXXX	0.250	0.140	6.35	3.56
19-04-21162-XXXX	0.250	0.147	6.35	3.73
19-04-12792-XXXX	0.250	0.150	6.35	3.81
19-04-15443-XXXX	0.250	0.187	6.35	4.75
19-04-21161-XXXX	0.250	0.192	6.35	4.88
19-04-14349-XXXX	0.250	0.200	6.35	5.08
19-04-W049-XXXX	0.290	0.156	7.37	3.96
10-04-3221-XXXX	0.290	0.175	7.37	4.44
19-04-19133-XXXX	0.312	0.115	7.92	2.92
10-04-3004-XXXX	0.312	0.192	7.92	4.88
19-04-16906-XXXX	0.335	0.202	8.51	5.13
19-04-22253-XXXX	0.343	0.168	8.71	4.27
19-04-13759-XXXX	0.348	0.250	8.84	6.35
19-04-14292-XXXX	0.373	0.200	9.47	5.08
10-04-3122-XXXX	0.375	0.250	9.52	6.35
19-04-12102-XXXX	0.376	0.148	9.55	3.76
19-04-22230-XXXX	0.390	0.295	9.91	7.49
19-04-19324-XXXX	0.390	0.328	9.91	8.33
19-04-14467-XXXX	0.394	0.253	10.01	6.43
19-04-12338-XXXX	0.430	0.330	10.92	8.38
19-04-3685-XXXX	0.437	0.250	11.10	6.35
10-04-4034-XXXX	0.437	0.347	11.10	8.81
19-04-14261-XXXX	0.461	0.295	11.71	7.49
10-04-3649-XXXX	0.470	0.345	11.94	8.76
19-04-11651-XXXX	0.524	0.315	13.31	8.00
19-04-22208-XXXX	0.543	0.184	13.79	4.67
19-04-21440-XXXX	0.545	0.395	13.84	10.03
10-04-5516-XXXX	0.620	0.515	15.75	13.08
19-04-15181-XXXX	0.625	0.250	15.88	6.35
10-04-4148-XXXX	0.630	0.515	16.00	13.08
19-04-23379-XXXX	0.644	0.581	16.36	14.76
19-04-21493-XXXX	0.676	0.613	17.17	15.57
19-04-11875-XXXX	0.812	0.500	20.62	12.70
19-04-20951-XXXX	0.893	0.770	22.68	19.56
19-04-17364-XXXX	1.240	1.150	31.50	29.21

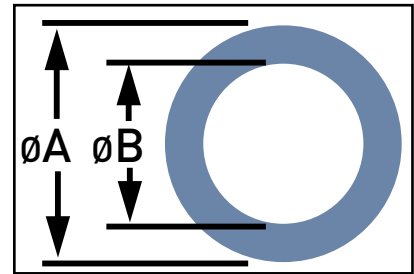

NOTE:  
Due to the hollow profile's nature, multiple groove sizes are possible. Contact Chomerics Applications Engineering for design assistance.

Standard Tolerances (inch)

- <0.200: ±0.005
- 0.200 - 0.349: ±0.008
- 0.350 - 0.500: ±0.010
- >0.500: ±3% Nom. Dim.

Dimensions listed for reference only.  
Please see Chomerics drawing for revision-controlled specifications.  
Contact Chomerics Applications Engineering for groove design assistance.

## Profile Description: P Shape

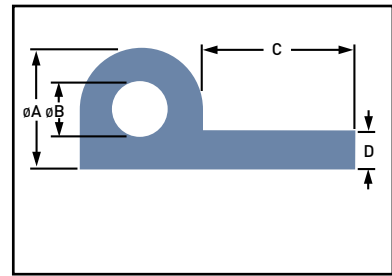

Table 10: Profiles, P-Shape (Sorted by "A" Dimension)

Part Number	Nominal Dimension (inch)				Nominal Dimension (mm)			
	A	B	C	D	A	B	C	D
19-06-12489-XXXX	0.075	0.025	-	0.045	1.90	0.64	-	1.14
19-06-10819-XXXX	0.076	0.028	0.124	0.033	1.93	0.71	3.15	0.84
19-06-M151-XXXX	0.125	0.045	0.250	0.062	3.17	1.14	6.35	1.57
19-06-Z731-XXXX	0.140	0.100	0.135	0.030	3.56	2.54	3.43	0.76
19-06-C442-XXXX	0.164	0.084	0.040	0.095	4.17	2.13	1.02	2.41
19-06-M412-XXXX	0.168	0.047	0.200	0.062	4.27	1.19	5.08	1.57
10-06-B227-XXXX	0.190	0.130	0.312	0.062	4.83	3.30	7.92	1.57
19-06-20879-XXXX	0.190	0.136	0.312	0.030	4.83	3.45	7.92	0.76
10-06-A778-XXXX	0.200	0.080	0.215	0.062	5.08	2.03	5.46	1.57
19-06-11223-XXXX	0.200	0.080	0.310	0.052	5.08	2.03	7.87	1.32
10-06-8560-XXXX	0.200	0.080	0.425	0.062	5.08	2.03	10.80	1.57
19-06-12942-XXXX	0.200	0.080	0.400	0.062	5.08	2.03	10.16	1.57
10-06-8550-XXXX	0.200	0.080	0.275	0.062	5.08	2.03	6.99	1.57
10-06-8737-XXXX	0.200	0.080	0.250	0.062	5.08	2.03	6.35	1.57
19-06-13514-XXXX	0.200	0.080	0.125	0.062	5.08	2.03	3.17	1.57
10-06-6175-XXXX	0.200	0.080	0.550	0.062	5.08	2.03	13.97	1.57
10-06-3599-XXXX	0.200	0.080	0.650	0.062	5.08	2.03	16.51	1.57
19-06-13217-XXXX	0.200	0.125	0.650	0.062	5.08	3.17	16.51	1.57
10-06-6180-XXXX	0.250	0.125	0.625	0.062	6.35	3.17	15.88	1.57
10-06-4142-XXXX	0.250	0.125	0.250	0.062	6.35	3.17	6.35	1.57
10-06-3300-XXXX	0.250	0.125	0.375	0.062	6.35	3.17	9.52	1.57
10-06-4921-XXXX	0.250	0.150	0.375	0.062	6.35	3.81	9.52	1.57
10-06-8778-XXXX	0.250	0.250	0.350	0.062	6.35	6.35	8.89	1.57
10-06-C716-XXXX	0.254	0.153	0.254	0.062	6.45	3.89	6.45	1.57
19-06-22037-XXXX	0.310	0.210	0.145	0.050	7.87	5.33	3.68	1.27
10-06-5611-XXXX	0.312	0.187	0.563	0.062	7.92	4.75	14.30	1.57
10-06-2750-XXXX	0.360	0.255	0.420	0.070	9.14	6.48	10.67	1.78
19-06-16770-XXXX	0.375	0.250	0.625	0.075	9.52	6.35	15.88	1.90
19-06-L064-XXXX	0.600	0.400	0.350	0.110	15.24	10.16	8.89	2.79
19-06-15899-XXXX	0.610	0.350	0.875	0.130	15.49	8.89	22.22	3.30
19-06-11384-XXXX	0.750	0.625	0.725	0.062	19.05	15.88	18.41	1.57

### Standard Tolerances (inch)

- <0.200: ±0.005
- 0.200 - 0.349: ±0.008
- 0.350 - 0.500: ±0.010
- >0.500: ±3% Nom. Dim.

Dimensions listed for reference only.

Please see Chomerics drawing for revision-controlled specifications.

Contact Chomerics Applications Engineering for groove design assistance.

## Profile Description: Channel Shape

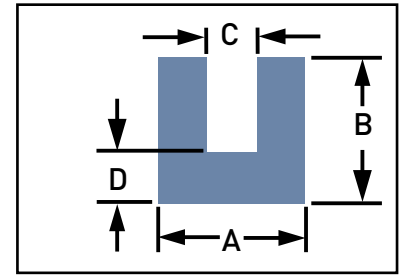

Table 11: Profiles, Channel-Shape (Sorted by "A" Dimension)

Part Number	Nominal Dimension (inch)				Nominal Dimension (mm)			
	A	B	C	D	A	B	C	D
19-08-14054-XXXX	0.075	0.099	0.025	0.032	1.90	2.51	0.64	0.81
10-08-6475-XXXX	0.100	0.100	0.034	0.033	2.54	2.54	0.86	0.84
19-08-22217-XXXX	0.125	0.188	0.025	0.062	3.17	4.78	0.64	1.57
19-08-12880-XXXX	0.126	0.078	0.044	0.048	3.20	1.98	1.12	1.22
19-08-12881-XXXX	0.126	0.099	0.047	0.059	3.20	2.51	1.19	1.50
10-08-3215-XXXX	0.126	0.110	0.025	0.050	3.20	2.79	0.64	1.27
10-08-4315-XXXX	0.126	0.225	0.020	0.075	3.20	5.71	0.51	1.90
19-08-17623-XXXX	0.154	0.114	0.082	0.048	3.91	2.90	2.08	1.22
10-08-3157-XXXX	0.156	0.156	0.062	0.047	3.96	3.96	1.57	1.19
19-08-12844-XXXX	0.156	0.175	0.046	0.075	3.96	4.44	1.17	1.90
10-08-3253-XXXX	0.175	0.156	0.047	0.075	4.44	3.96	1.19	1.90
10-08-F815-XXXX	0.188	0.188	0.062	0.062	4.78	4.78	1.57	1.57
19-08-23568-XXXX	0.190	0.270	0.050	0.065	4.83	6.86	1.27	1.65
19-08-C929-XXXX	0.250	0.250	0.130	0.062	6.35	6.35	3.30	1.57
19-08-12885-XXXX	0.260	0.184	0.140	0.062	6.60	4.67	3.56	1.57
19-08-17068-XXXX	0.312	0.187	0.190	0.061	7.92	4.75	4.83	1.55
19-08-12886-XXXX	0.320	0.315	0.193	0.197	8.13	8.00	4.90	5.00
10-08-3872-XXXX	0.327	0.235	0.062	0.115	8.31	5.97	1.57	2.92
10-08-8754-XXXX	0.330	0.215	0.170	-	8.38	5.46	4.32	-
19-08-E622-XXXX	0.375	0.500	0.187	0.125	9.52	12.70	4.75	3.17

### Standard Tolerances (inch)

- <0.200:  $\pm 0.005$
- 0.200 - 0.349:  $\pm 0.008$
- 0.350 - 0.500:  $\pm 0.010$
- >0.500:  $\pm 3\%$  Nom. Dim.

Dimensions listed for reference only.

Please see Chomerics drawing for revision-controlled specifications.

Contact Chomerics Applications Engineering for groove design assistance.

## Profile Description: D Shape

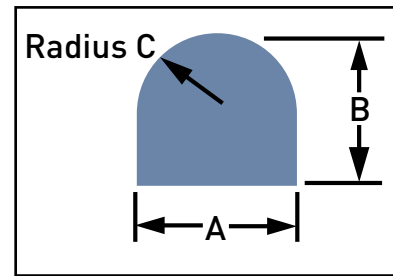

Table 12: Profiles, D-Shape (Sorted by "B" Dimension)

Part Number	Nominal Dimension (inch)			Nominal Dimension (mm)		
	A	B	C	A	B	C
19-05-2116-XXXX	0.035	0.035	0.018	0.89	0.89	0.46
19-05-16047-XXXX	0.021	0.040	0.010	0.53	1.02	0.25
19-05-20935-XXXX	0.150	0.052	0.200	3.81	1.32	5.08
19-05-23350-XXXX	0.032	0.059	-	0.81	1.50	-
19-05-14769-XXXX	0.035	0.062	0.018	0.89	1.57	0.46
10-05-5589-XXXX	0.055	0.064	0.031	1.40	1.63	0.79
10-05-1362-XXXX	0.062	0.068	0.031	1.57	1.73	0.79
19-05-14422-XXXX	0.055	0.070	0.055	1.40	1.78	1.40
19-05-E163-XXXX	0.062	0.074	0.031	1.57	1.88	0.79
10-05-Z337-XXXX	0.060	0.075	0.030	1.52	1.90	0.76
10-05-3224-XXXX	0.094	0.078	0.047	2.39	1.98	1.19
19-05-12888-XXXX	0.088	0.081	0.044	2.24	2.06	1.12
19-05-12883-XXXX	0.062	0.085	0.031	1.57	2.16	0.79
10-05-1363-XXXX	0.078	0.089	0.039	1.98	2.26	0.99
19-05-Z586-XXXX	0.094	0.094	0.047	2.39	2.39	1.19
10-05-4699-XXXX	0.062	0.100	0.031	1.57	2.54	0.79
19-05-23159-XXXX	0.125	0.110	-	3.17	2.79	-
10-05-2618-XXXX	0.150	0.110	0.075	3.81	2.79	1.90
19-05-C128-XXXX	0.102	0.115	0.051	2.59	2.92	1.30
19-05-21124-XXXX	0.165	0.118	-	4.19	3.00	-
19-05-F084-XXXX	0.125	0.125	0.062	3.17	3.17	1.57
10-05-A283-XXXX	0.122	0.131	0.061	3.10	3.33	1.55
19-05-A611-XXXX	0.091	0.134	0.045	2.31	3.40	1.14
10-05-1364-XXXX	0.122	0.135	0.061	3.10	3.43	1.55
19-05-11558-XXXX	0.098	0.150	0.039	2.49	3.81	0.99
10-05-1499-XXXX	0.118	0.156	0.059	3.00	3.96	1.50
19-05-F173-XXXX	0.156	0.156	0.078	3.96	3.96	1.98
10-05-1577-XXXX	0.178	0.175	0.089	4.52	4.44	2.26
19-05-W469-XXXX	0.188	0.188	0.094	4.78	4.78	2.39
10-05-A381-XXXX	0.187	0.200	0.093	4.75	5.08	2.36

### Standard Tolerances (inch)

- <0.200: ±0.005
- 0.200 - 0.349: ±0.008
- 0.350 - 0.500: ±0.010
- >0.500: ±3% Nom. Dim.

Dimensions listed for reference only.

Please see Chomerics drawing for revision-controlled specifications.

Contact Chomerics Applications Engineering for groove design assistance.

## Profile Description: Hollow D Shape

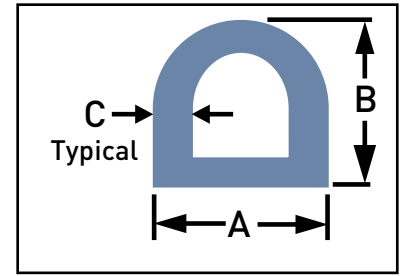

Table 13: Profiles, Hollow D-Shape (Sorted by "B" Dimension)

Part Number	Nominal Dimension (inch)				Nominal Dimension (mm)			
	A	B	C	D	A	B	C	D
19-05-24810-XXXX	0.125	0.093	0.025	-	3.17	2.36	0.64	-
19-05-23617-XXXX	0.085	0.095	0.020	-	2.16	2.41	0.51	-
19-05-11440-XXXX	0.246	0.145	0.030	-	6.25	3.68	0.76	-
19-05-9514-XXXX	0.100	0.148	0.040	-	2.54	3.76	1.02	-
19-05-15343-XXXX	0.125	0.156	0.040	-	3.17	3.96	1.02	-
19-05-20355-XXXX	0.135	0.156	0.040	-	3.43	3.96	1.02	-
10-05-6419-XXXX	0.156	0.156	0.045	-	3.96	3.96	1.14	-
19-05-21357-XXXX	0.200	0.156	0.045	-	5.08	3.96	1.14	-
19-05-19354-XXXX	0.126	0.185	0.028	-	3.20	4.70	0.71	-
19-05-17261-XXXX	0.186	0.186	0.040	-	4.72	4.72	1.02	-
10-05-4202-XXXX	0.187	0.187	0.050	-	4.75	4.75	1.27	-
19-05-11231-XXXX	0.207	0.187	0.050	-	5.26	4.75	1.27	-
19-05-10277-XXXX	0.296	0.187	0.030	-	7.52	4.75	0.76	-
19-05-21741-XXXX	0.296	0.187	0.030	-	7.52	4.75	0.76	-
19-05-L467-XXXX	0.296	0.187	0.050	-	7.52	4.75	1.27	-
19-05-17485-XXXX	0.217	0.188	0.030	-	5.51	4.78	0.76	-
19-05-X254-XXXX	0.187	0.227	0.040	-	4.75	5.77	1.02	-
19-05-16720-XXXX	0.400	0.230	0.035	-	10.16	5.84	0.89	-
10-05-6991-XXXX	0.250	0.250	0.062	-	6.35	6.35	1.57	-
10-05-6394-XXXX	0.250	0.250	0.065	-	6.35	6.35	1.65	-
10-05-4308-XXXX	0.312	0.312	0.062	-	7.92	7.92	1.57	-
19-05-19369-XXXX	0.312	0.312	0.038	-	7.92	7.92	0.97	-
19-05-C589-XXXX	0.488	0.312	0.055	-	12.40	7.92	1.40	-
19-05-16657-XXXX	0.487	0.324	0.055	-	12.37	8.23	1.40	-
19-05-12375-XXXX	0.487	0.324	0.062	-	12.37	8.23	1.57	-
10-05-4542-XXXX	0.487	0.324	0.080	-	12.37	8.23	2.03	-
19-05-12066-XXXX	0.487	0.324	0.045	-	12.37	8.23	1.14	-
19-05-20410-XXXX	0.750	0.324	0.062	-	19.05	8.23	1.57	-
19-05-E429-XXXX	0.500	0.500	0.062	-	12.70	12.70	1.57	-
10-05-4282-XXXX	0.700	0.600	0.100	-	17.78	15.24	2.54	-
19-05-L362-XXXX	0.750	0.750	0.075	-	19.05	19.05	1.90	-

### Standard Tolerances (inch)

- <0.200: ±0.005
- 0.200 - 0.349: ±0.008
- 0.350 - 0.500: ±0.010
- >0.500: ±3% Nom. Dim.

Dimensions listed for reference only.

Please see Chomerics drawing for revision-controlled specifications.

Contact Chomerics Applications Engineering for groove design assistance.

## Profile Description: Rectangular Strip Shape

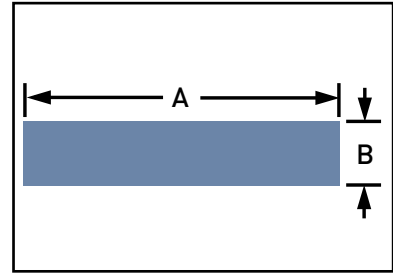

Table 14: Profiles, Rectangular Strip-Shape (Sorted by "B" Dimension)

Part Number	Nominal Dimension (inch)				Nominal Dimension (mm)			
	A	B	C	D	A	B	C	D
19-07-21642-XXXX	0.188	0.031	-	-	4.78	0.79	-	-
19-07-10959-XXXX	0.870	0.032	-	-	22.10	0.81	-	-
19-07-Z499-XXXX	0.114	0.039	-	-	2.90	0.99	-	-
19-07-11206-XXXX	0.120	0.040	-	-	3.05	1.02	-	-
19-07-12675-XXXX	0.500	0.040	-	-	12.70	1.02	-	-
10-07-4272-XXXX	0.063	0.042	-	-	1.60	1.07	-	-
19-07-11081-XXXX	1.000	0.042	-	-	25.40	1.07	-	-
19-07-21881-XXXX	0.177	0.045	-	-	4.50	1.14	-	-
19-07-19506-XXXX	0.320	0.045	-	-	8.13	1.14	-	-
19-07-20218-XXXX	0.157	0.050	-	-	3.99	1.27	-	-
19-07-20362-XXXX	0.157	0.059	-	-	3.99	1.50	-	-
10-07-F743-XXXX	0.375	0.060	-	-	9.52	1.52	-	-
19-07-12959-XXXX	0.640	0.060	-	-	16.26	1.52	-	-
10-07-L525-XXXX	1.120	0.060	-	-	28.45	1.52	-	-
19-07-12949-XXXX	0.095	0.062	-	-	2.41	1.57	-	-
10-07-2981-XXXX	0.095	0.062	-	-	2.41	1.57	-	-
10-07-3225-XXXX	0.125	0.062	-	-	3.17	1.57	-	-
10-07-3047-XXXX	0.156	0.062	-	-	3.96	1.57	-	-
19-07-F463-XXXX	0.188	0.062	-	-	4.78	1.57	-	-
10-07-3226-XXXX	0.250	0.062	-	-	6.35	1.57	-	-
19-07-L463-XXXX	0.390	0.062	-	-	9.91	1.57	-	-
19-07-12200-XXXX	0.500	0.062	-	-	12.70	1.57	-	-
19-07-12958-XXXX	0.569	0.062	-	-	14.45	1.57	-	-
19-07-11294-XXXX	0.750	0.062	-	-	19.05	1.57	-	-
10-07-4483-XXXX	0.750	0.062	-	-	19.05	1.57	-	-
19-07-22989-XXXX	0.825	0.062	-	-	20.95	1.57	-	-
10-07-4523-XXXX	0.880	0.062	-	-	22.35	1.57	-	-
19-07-E431-XXXX	1.000	0.062	-	-	25.40	1.57	-	-
10-07-4538-XXXX	1.180	0.062	-	-	29.97	1.57	-	-
19-07-12961-XXXX	1.210	0.062	-	-	30.73	1.57	-	-
19-07-16941-XXXX	1.250	0.062	-	-	31.75	1.57	-	-
19-07-W391-XXXX	1.600	0.062	-	-	40.64	1.57	-	-
19-07-F067-XXXX	2.000	0.062	-	-	50.80	1.57	-	-
19-07-12954-XXXX	0.255	0.063	-	-	6.48	1.60	-	-
19-07-12956-XXXX	0.508	0.063	-	-	12.90	1.60	-	-
10-07-4014-XXXX	0.120	0.075	-	-	3.05	1.90	-	-
10-07-3522-XXXX	0.500	0.075	-	-	12.70	1.90	-	-
19-07-12948-XXXX	0.085	0.085	-	-	2.16	2.16	-	-

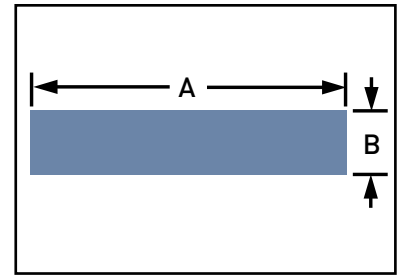

Table 14: Profiles, Rectangular Strip-Shape (Sorted by "B" Dimension) (Cont.)

Part Number	Nominal Dimension (inch)				Nominal Dimension (mm)			
	A	B	C	D	A	B	C	D
19-07-11080-XXXX	1.000	0.090	-	-	25.40	2.29	-	-
19-07-12953-XXXX	0.188	0.093	-	-	4.78	2.36	-	-
19-07-12491-XXXX	0.500	0.093	-	-	12.70	2.36	-	-
19-07-11079-XXXX	0.780	0.100	-	-	19.81	2.54	-	-
19-07-13026-XXXX	0.188	0.125	-	-	4.78	3.17	-	-
19-07-21339-XXXX	0.250	0.125	-	-	6.35	3.17	-	-
10-07-4217-XXXX	0.500	0.125	-	-	12.70	3.17	-	-
19-07-12877-XXXX	0.620	0.125	-	-	15.75	3.17	-	-
19-07-11495-XXXX	0.880	0.125	-	-	22.35	3.17	-	-
19-07-8345-XXXX	0.980	0.125	-	-	24.89	3.17	-	-
19-07-12951-XXXX	0.126	0.126	-	-	3.20	3.20	-	-
19-07-12957-XXXX	0.564	0.127	-	-	14.33	3.23	-	-
19-07-F627-XXXX	0.219	0.156	-	-	5.56	3.96	-	-
10-07-14592-XXXX	0.438	0.188	-	-	11.13	4.78	-	-
10-07-3080-XXXX	0.500	0.188	-	-	12.70	4.78	-	-
10-07-B447-XXXX	0.500	0.250	-	-	12.70	6.35	-	-
10-07-3797-XXXX	1.000	0.250	-	-	25.40	6.35	-	-
19-07-12955-XXXX	0.330	0.305	-	-	8.38	7.75	-	-
19-07-L956-XXXX	0.875	0.312	-	-	22.22	7.92	-	-
19-07-16977-XXXX	1.250	0.500	-	-	31.75	12.70	-	-

Standard Tolerances (inch)

- <0.200: ±0.005
- 0.200 - 0.349: ±0.008
- 0.350 - 0.500: ±0.010
- >0.500: ±3% Nom. Dim.

Dimensions listed for reference only.

Please see Chomerics drawing for revision-controlled specifications.

Contact Chomerics Applications Engineering for groove design assistance.

## Profile Description: Hollow Rectangle Shape

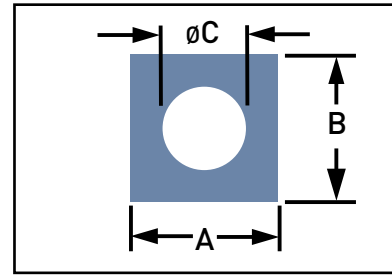

Table 15: Profiles, Hollow Rectangle-Shape (Sorted by "B" Dimension)

Part Number	Nominal Dimension (inch)			Nominal Dimension (mm)		
	A	B	C	A	B	C
10-07-13944-XXXX	0.100	0.059	0.020	2.54	1.50	0.51
19-07-15804-XXXX	0.126	0.126	0.048	3.20	3.20	1.22
19-09-22260-XXXX*	0.500	0.280	-	12.70	7.11	-
10-07-2998-XXXX	0.305	0.330	0.125	7.75	8.38	3.17
10-07-4481-XXXX	0.375	0.375	0.188	9.52	9.52	4.78
10-07-E263-XXXX	0.500	0.500	0.250	12.70	12.70	6.35

\*Profile 19-09-22260 is symmetrical hollow rectangle with 0.060 in. interior wall.

### Standard Tolerances (inch)

- <0.200: ±0.005
- 0.200 - 0.349: ±0.008
- 0.350 - 0.500: ±0.010
- >0.500: ±3% Nom. Dim.

Dimensions listed for reference only.

Please see Chomerics drawing for revision-controlled specifications.

Contact Chomerics Applications Engineering for groove design assistance.

## Profile Description: Mushroom D Shape

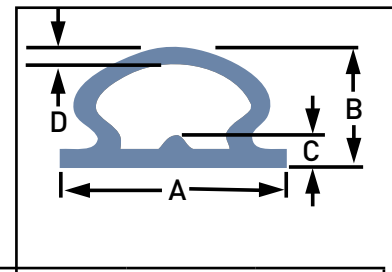

Table 16: Profiles, Mushroom D-Shape (Sorted by "B" Dimension)

Part Number	Nominal Dimension (inch)				Nominal Dimension (mm)			
	A	B	C	D	A	B	C	D
19-09-16802-XXXX	0.315	0.301	0.109	0.053	8.00	7.65	2.77	1.35
19-09-16503-XXXX	0.265	0.312	0.113	0.040	6.73	7.92	2.87	1.02
19-05-14587-XXXX	0.487	0.324	0.115	0.055	12.37	8.23	2.92	1.40
19-09-14377-XXXX	0.625	0.375	0.106	0.057	15.88	9.52	2.69	1.45
19-09-14926-XXXX	0.625	0.400	0.106	0.057	15.88	10.16	2.69	1.45
19-05-14282-XXXX	0.645	0.427	0.065	0.065	16.38	10.85	1.65	1.65
19-09-16339-XXXX	0.472	0.433	0.115	0.040	11.99	11.00	2.92	1.02
19-09-15486-XXXX	0.846	0.472	0.120	0.053	21.49	11.99	3.05	1.35
19-09-15523-XXXX	0.890	0.730	0.183	0.065	22.61	18.54	4.65	1.65

### Standard Tolerances (inch)

- <0.200: ±0.005
- 0.200 - 0.349: ±0.008
- 0.350 - 0.500: ±0.010
- >0.500: ±3% Nom. Dim.

Dimensions listed for reference only.

Please see Chomerics drawing for revision-controlled specifications.

Contact Chomerics Applications Engineering for groove design assistance.